



ModernView™
DECKING

- ★ Place In-ground, On-ground or In-Water
- ★ Universal / Dual Side Embossing
- ★ LEED Certified
- ★ 95% Recycled Content
- ★ *25 Year LIMITED WARRANTY

Decking Systems

AVAILABLE IN FOUR COLORS

AUBURN

Grooved & Square Edge

ACTUAL DIMENSIONS:

1.0" x 5.0"

LENGTH: 12, 16 and 20 feet

JAVA

AMBER

SLATE



Trim Board

ACTUAL DIMENSIONS:

0.65" x 11.25"

LENGTH: 12 feet

Tools

All you'll need is a hammer and screw gun, circular saw (carbide-tipped blade with fewer than 20 teeth is recommended), level, tape measure, rasp and blue chalk line. Manufacturer recommends blue chalk since other colored chalk may stain the deck.

installation care & maintenance instructions



As with any building project, use proper eye and ear protection and follow local building codes. ModernView® composite decking is for decking and accessories only. It is not to be used as structural material.

Hidden Fasteners

Our products are compatible with most hidden fastener systems. Please consult the installation instructions provided by the hidden fastener manufacturer.

General Cleaning & Maintenance Instructions

In an outdoor environment, periodic cleaning will help keep your deck looking new. As with any flooring surface, periodic cleaning is recommended.

The following are suggested cleaners for occasional maintenance:

- Olympic® Premium Deck Cleaner
- Behr® 63 Deck Wash
- Jomax® Deck Cleaner
- Concrobium XT Eco-Wash™ (non-bleach)

For specific cleaning issues, please visit our website www.ModernViewDecking.com

25 Year LIMITED WARRANTY

*See full A.E.R.T. warranty available at www.ModernViewDecking.com

1

Layout and install joists at either 16-inch on-center (OC) when decking will be installed perpendicular to the joists, or 12-inch (OC) when deck boards will be installed diagonally or at an angle to the joists. Joists must be level.

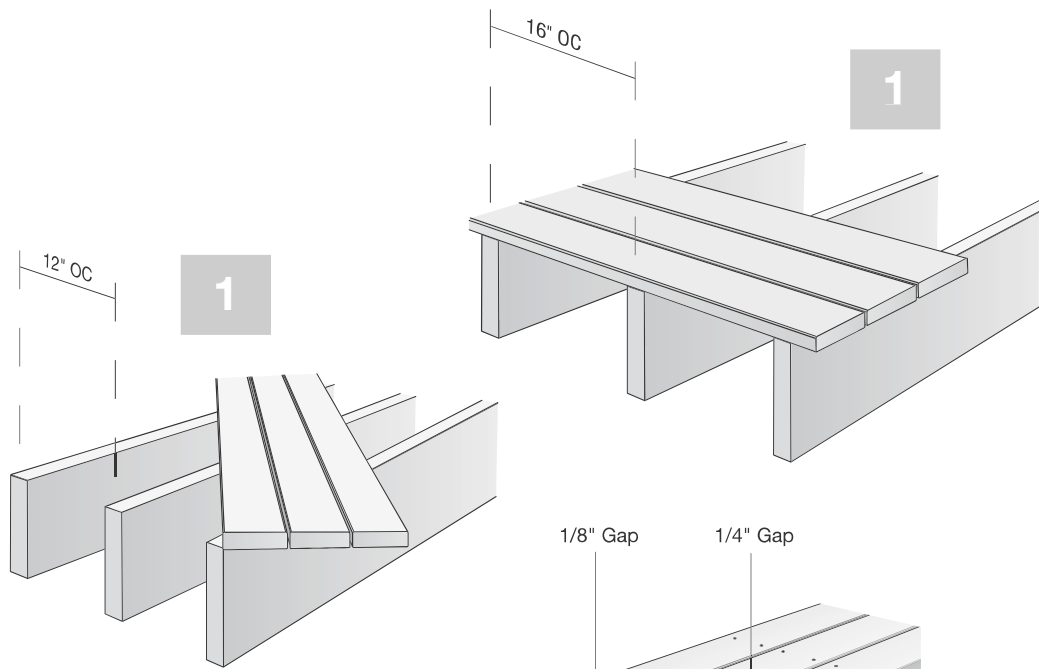

2

Install ModernView Decking® using 2-1/4-inch, #7 stainless steel trim head screws, two screws per board per joist recommended. Screws should be a minimum of 1/2-inch from the board end.

Allow 1/4-inch side-to-side spacing between deck boards. Allow 1/8-inch (or greater) end-to-end spacing between ends of boards (butt joints). If installing in freezing weather, leave 1/4-inch (butt joints).

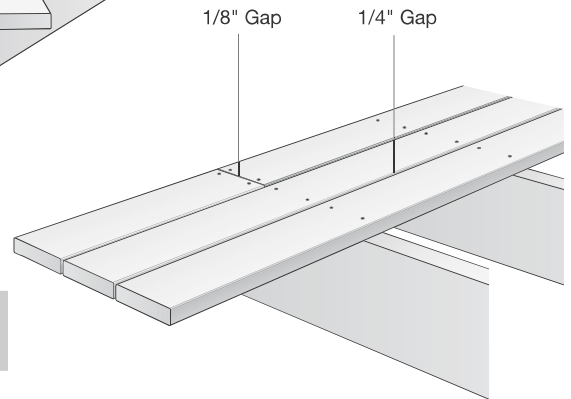

INSTALLATION TIPS:

- Double joist at butt joint to ensure plenty of room for fasteners.
- Pre-drill using a 7/64-inch bit when too close to the edge to prevent splitting. Drive screw at a slight angle into joist.

3

Additionally, for a finished look, install trim boards over the rim joists. Position flush with the top of the decking.

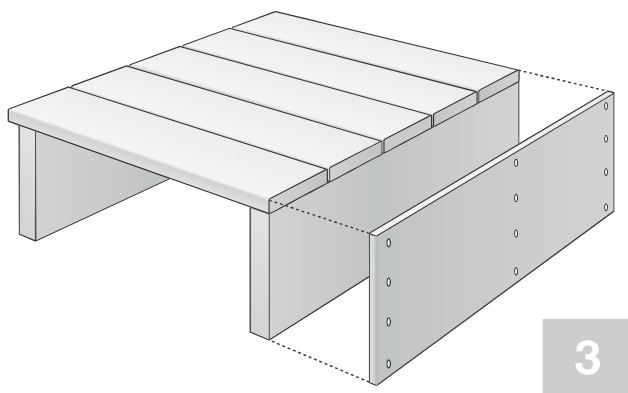

A. Attach using 2-1/4-inch, #7 stainless steel trim head screws. One screw through the end or side of the decking, and three screws into the rim joist vertically. Repeat this step every 10-12 inches horizontally through the length of the trim board.

B. We recommend putting the screw through the thickest part of the deck board when attaching the trim board, then the other three into the rim joist.